

# RESTRICTION ORIFICE PLATES

**Standard Bore**



A Restriction Orifice Plate is a device used to restrict flow. It reduces flow and pressure from the upstream side to the downstream side. This is beneficial in order to reduce noise and protect downstream equipment.

**Flow Measuring Orifice Plates are also available.**

Please contact Titan directly for more information regarding Flow Measuring Orifice Plates.

**Multi-Hole Bore**



Model	Material
RP 21 CS	Carbon Steel
RP 21 SS	Stainless Steel

## Materials

Standard materials for orifice plates are stainless steel and carbon steel. Contact factory for additional materials such as ceramic, fiberglass reinforced plastic, duplex stainless steel, etc.

## Bore Diameter

Sizing of the restriction orifice is specified by the customer in order to meet specific application requirements. For reference, see below for common design options.

## Codes & Standards

Currently, there are no corresponding codes or standards that address Restriction Orifice Plates.

## Handles

Orifice plates can be ordered with or without a handle. Handles are generally 1" wide by 3 3/4" long.

## Additional Design Options

Restriction Orifice plates can have a variety of specifications. Bores can be placed concentrically or eccentrically with the pipe and can have a full or segmented opening.

**Eccentric Bore**



**Multi-Stage Restriction Plate Assembly**

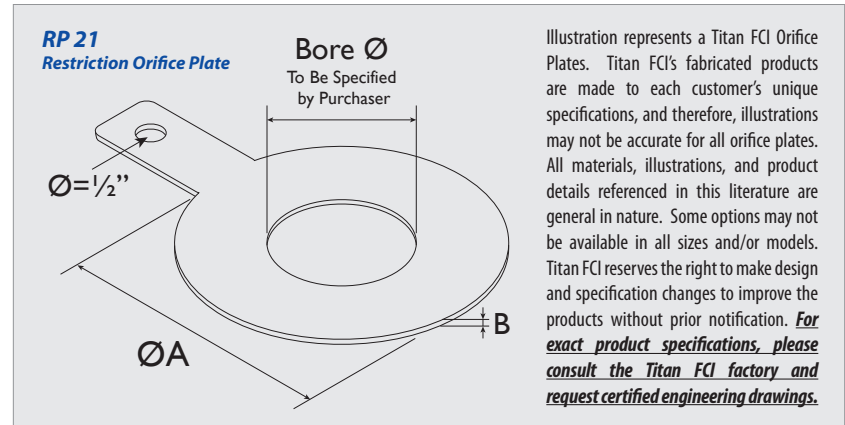
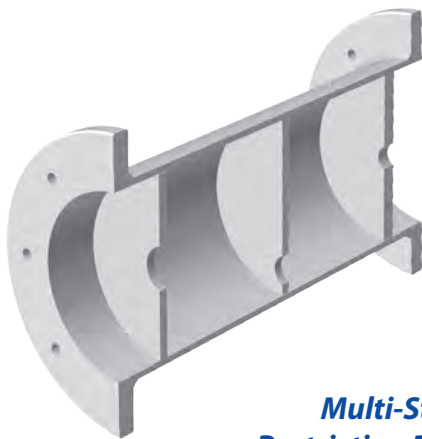

All pictures shown are for illustrative purposes only. Actual product may vary due to product enhancement.